

4,200 sf

/Programming
/Space planning
/Design development

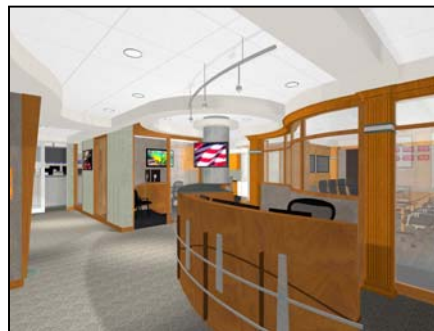

This project involved the renovation of a Situation Suite in The White House. The design consists of flexible work areas for a highly energetic West Wing staff. The space layout employs hierarchical placement of use functions to facilitate the receipt, dissemination, and analysis of information critical to the President's senior administration members. Rooms are organized along two diverse and redundant corridors, allowing optimum accessibility to all suite areas while mitigating occupant congestion. The combination of low partitions, glass transparencies, and custom work surfaces are used to form the major spatial divides, creating an expansive environment within a modest interior envelope.

